

## JUNCTION BOXES FOR ELECTRICAL INSTALLATION



## REFERENCE STANDARDS

**EN 60670-1**  
Boxes and enclosures for electrical accessories for household and similar fixed electrical installations.  
*Part 1: general requirements.*

**EN 60670-22**  
Boxes and enclosures for electrical accessories for household and similar fixed electrical installations.  
*Part 22: particular requirements for connecting boxes and enclosures.*

## QUALITY MARKS



## TECHNICAL CHARACTERISTICS

Protection degree:	<b>IP44-IP55-IP56</b>
Operating temperature according to the reference standard:	<b>-25°C +35°C</b>
Max operating temperature:	<b>60°C</b>
Glow wire test:	<b>650°C</b>
Material:	<b>Engineering plastic</b>
IK degree at 20°C:	<b>IK04 - IK08</b>
Total insulation $\square$ :	<b>Yes</b>
Halogen free:	<b>Yes (blank sides versions)</b>
DIN rail fixing:	<b>Yes</b>
Colour:	<b>Grey RAL 7035</b>

## VERSIONS

	With cable sleeves - IP44 - With press-fit cover
	With cable sleeves - IP55 - With screw-down cover
	With blank sides - IP56 - With screw-down cover
	With blank sides - IP56 - Higer box with screw-down cover

## BEHAVIOUR WITH CHEMICAL AND ATMOSPHERIC AGENTS

Saline solution	Acids		Bases		Solvents				Mineral oil	UV rays
	Concentrated	Diluted	Concentrated	Diluted	Hexane	Benzol	Acetone	Alcohol		
Resistant	Limited Resistance	Resistant	Limited Resistance	Resistant	Not Resistant	Not Resistant	Not Resistant	Limited Resistance	Limited Resistance	Resistant

## DIMENSIONS

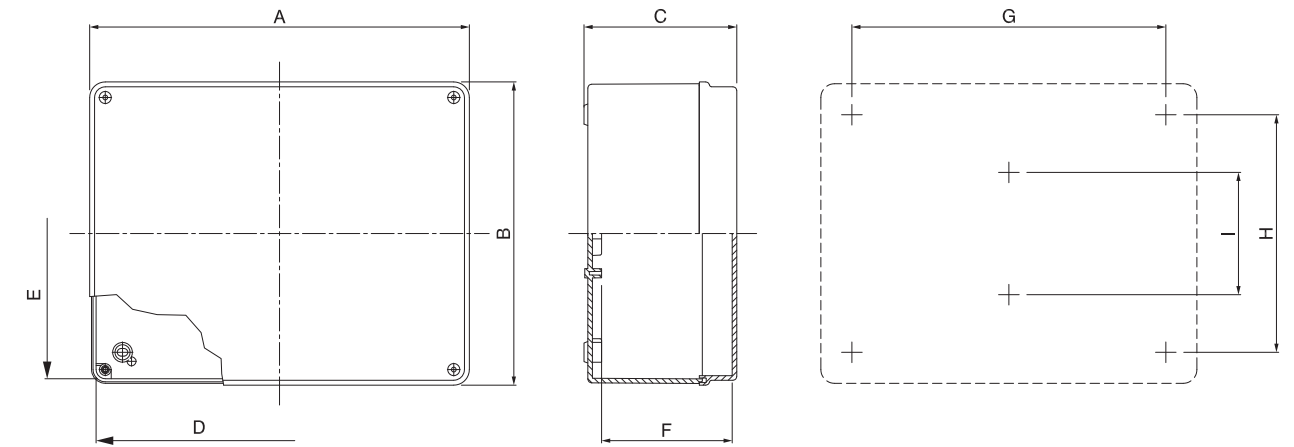

	Internal dimensions			External dimensions			Wall mounted		
	D	E	F	A	B	C	G	H	I
	mm	mm	mm	mm	mm	mm	mm	mm	mm
<b>680.001</b>	Ø65	Ø65	35	Ø76	Ø73	41	/	/	32
<b>680.002</b>	Ø80	Ø80	40	Ø87	Ø87	46	/	/	46
<b>680.003</b>	80	80	40	87	87	46	/	/	46
<b>685.004</b>	100	100	50	108	108	58	64	64	/
<b>685.005</b>	120	80	50	128	88	58	84	44	/
<b>685.006</b>	150	110	70	158	118	76	114	74	/
<b>685.007</b>	190	140	70	198	148	80	155	105	/
<b>685.008</b>	240	190	90	248	198	100	205	155	/
<b>685.009</b>	300	220	120	308	228	129	265	185	/
<b>685.010</b>	380	300	120	388	308	129	345	265	124
<b>685.011</b>	450	370	130	460	380	130	300	290	160
<b>686.204</b>	100	100	50	108	108	58	64	64	/
<b>686.205</b>	120	80	50	128	88	58	84	44	/
<b>686.206</b>	150	110	70	158	118	76	114	74	/
<b>686.207</b>	190	140	70	198	148	80	155	105	/
<b>686.208</b>	240	190	90	248	198	100	205	155	/
<b>686.209</b>	300	220	120	308	228	129	265	185	/
<b>686.210</b>	380	300	120	388	304	129	345	265	124
<b>686.211</b>	450	370	130	460	380	130	300	290	160
<b>686.404</b>	100	100	80	108	108	88	64	64	/
<b>686.408</b>	240	190	125	248	198	135	205	155	/
<b>686.409</b>	300	220	170	308	228	179	265	185	/
<b>686.410</b>	380	300	170	388	308	179	345	265	124
<b>686.411</b>	450	370	180	460	380	180	300	290	160

(Dimensions in mm)

# SCABOX Series

## Surface mounting junction boxes

 1  
2  
ENCLOSURES  
3

### BOX WITH CABLE SLEEVES



Cover	Dimensions (mm)	No. of inlets	For	Fixing screws	⊞	IP44	IP55
Release cover	ø65x35	4xø23mm	PG 16	2	4/100	⊕ 680.001	
	ø80x40	4xø23mm	PG 16	2	4/100	⊕ 680.002	
	80x80x40	6xø23mm	PG 16	2	4/60	⊕ 680.003	
Screw cover	100x100x50	6xø23mm	PG 21	4	1/48		⊕ 685.004
	120x80x50	6xø29mm	PG 21	4	1/54		⊕ 685.005
	150x110x70	10xø29mm	PG 21	4	1/40		⊕ 685.006 (K1)
	190x140x70	10xø38mm	PG 29	4	1/24		⊕ 685.007 (K1)
	240x190x90	12xø38mm	PG 29 (♦)	4	1/12		⊕ 685.008 (K1)
	300x220x120	12xø38mm	PG 29 (♦)	4	1/6		⊕ 685.009 (K1)
	380x300x120	12xø48mm	PG 36 (♦)	4	1/4		⊕ 685.010 (K1)
	450x370x130	14xø48mm	PG 36 (♦)	6	1		⊕ 685.011 (K2)

(♦) Suitable for the hinges mounting.

 (K1) It is possible to use the wall mounting brackets kit item 654.0021.  
 (K2) It is possible to use the wall mounting brackets kit item 654.0023.

### ACCESSORIES

Description	⊞	
Wall mounting brackets	K1	4 pieces 10 654.0021
	K2	4 pieces 10 654.0023
Cover sealing kit (*)		10 654.0032
Hinges kit		1/20 654.0085
Sealing caps		12 pieces 10/100 654.0080
	190x140	1 654.0787
	240x190	1 654.0788
	300x220	1 654.0789
	380x300	1 654.0790
Zinc-coated steel back plate		452x372 1 654.0791

(\*) For boses 190x140 - 240x190 - 300x220 - 380x300 - 450x370.

### BOX WITH BLANK SIDES



Cover	Dimensions (mm)	Fixing screws	⊞	IP56 - BLANK COVER	IP56 - CLEAR COVER	IP56 - HIGHER BOX BLANK COVER	IP56 - HIGHER BOX CLEAR COVER
Screw cover	100x100x50	4	1/40	⊕ 686.204	⊕ 686.224		
	100x100x80	4	1/24			⊕ 686.404	⊕ 686.424
	120x80x50	4	1/42	⊕ 686.205	⊕ 686.225		
	150x110x70	4	1/48	⊕ 686.206 (K1)	⊕ 686.226 (K1)		
	190x140x70	4	1/30	⊕ 686.207 (K1)	⊕ 686.227 (K1)		
	240x190x90	4 (♦)	1/16	⊕ 686.208 (K1)	⊕ 686.228 (K1)		
	240x190x125	4 (♦)	1/6			⊕ 686.408	⊕ 686.428
	300x220x120	4 (♦)	1/8	⊕ 686.209 (K1)	⊕ 686.229 (K1)		
	300x220x170	4 (♦)	1/6			⊕ 686.409	⊕ 686.429
	380x300x120	4 (♦)	1/4	⊕ 686.210 (K1)	⊕ 686.230 (K1)		
	380x300x170	6 (♦)	1/3			⊕ 686.410 (K1)	⊕ 686.430 (K1)
	450x370x130	6 (♦)	1	⊕ 686.211 (K2)	⊕ 686.231 (K2)		
	450x370x180	6 (♦)	1			⊕ 686.411 (K2)	⊕ 686.431 (K2)

(♦) Suitable for the hinges mounting.

 (K1) It is possible to use the wall mounting brackets kit item 654.0021.  
 (K2) It is possible to use the wall mounting brackets kit item 654.0023.

### T85 TERMINAL STRIPS

Connecting capacity (mm <sup>2</sup> )	Pitch (mm)	Dimen. (mm)	Fixing hole Ø (mm)	Rated voltage	⊞		
2,5	8	95,5x15,5x16	2,6	250V~	50/800	⊕ 815.2361	⊕ 815.2361B
4	10	120x16,6x17,4	3,5	450V~	50/400	⊕ 815.2362	⊕ 815.2362B
6	10	120x16,6x17,4	3,5	450V~	50/400	⊕ 815.23625	⊕ 815.23625B
10	11,5	138x23,5x20,5	3,5	450V~	25/300	⊕ 815.2363	⊕ 815.2363B
16	14,5	174x30x24	4,3	450V~	25/150	⊕ 815.2364	⊕ 815.2364B
25	17,5	210x38x36	4,3	750V~	15/60	⊕ 815.2365	⊕ 815.2365B
35	22	264x46x39	5,5	750V~	10/40	⊕ 815.2366	⊕ 815.2366B

 - Max. service temperature - continuous duty: 85°C.  
 - 12 poles.  
 - Colour: black or white.